

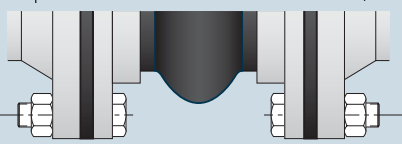

DILATOFLEX[®] M

- Inner lining grades**
- AR / CN**
Red label
 - GZ**
Orange label
 - EPC**
Cream label
 - YP**
Yellow label
 - AB**
Grey label
 - TE**
Mauve label
 - HH**
Blue label

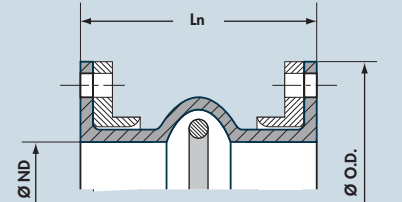
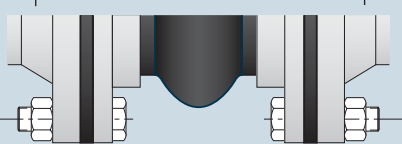
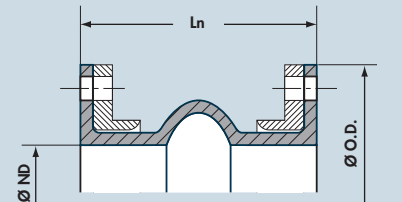
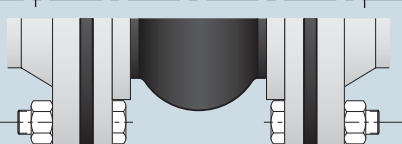
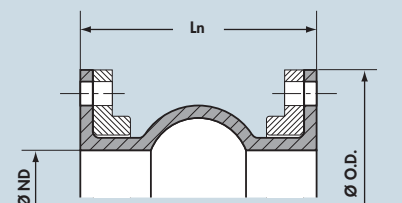
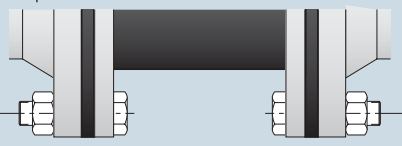
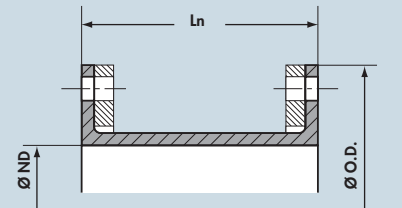

Example of Label



DIMENSIONAL DATA				TECHNICAL DATA										
Nominal Diameter	Nominal length (Ln in mm)	Drilling standards		Max. permissible pressure (bar)	Max permissible vacuum (% vacuum)	Max. Permissible Movements (not concurrent)						End thrust in daN for P=1 bar	Approx. weight in kg (with flanges) (1)	
		ISO 2084 NF EN 1759-1 NF EN 1092-1	PN 2.5 - PN 6 PN 10			Axial		Lateral	Angular					
ND mm	NPS inch	Other drillings Please consult us.				Compression Ln - Lc mm	Elongation Le - Ln mm	Shearing R mm	angle α° degree P V					
Type MD 40														
500	20	225	250	X	4	100%	20	0	30	2.3	1.7	2.3	42	
600	24	225	250	X	4	100%	20	0	30	1.9	1.4	3.2	53	
800	32		250	X	4	100%	20	0	30	1.4	1.1	5.6	82	
1000	40		250	300	X	4	100%	20	0	30	1.1	0.9	8.5	111
1200	48			300	X	4	100%	20	0	30	0.9	0.7	12.1	179
1400	56			300	X	4	100%	20	0	30	0.8	0.6	16.4	225
1600	64			300	X	4	100%	25	0	30	0.9	0.5	21.2	345
1800	72			300	X	4	100%	25	0	30	0.8	0.5	26.7	392
2000	80			300	X	4	100%	25	0	30	0.7	0.4	32.9	450
2200	88			300	X	4	100%	25	0	30	0.7	0.4	39.6	525
For any intermediate sizes and further sizes up to ND 2600mm (102"), please consult us.														
Type MS 50														
500	20		250	X	6	0%	20	15	30	4.0	-	2.4	49	
600	24		250	X	6	0%	20	15	30	3.3	-	3.4	60	
800	32		250	X	6	0%	20	15	30	2.5	-	5.8	92	
1000	40		250	300	X	6	0%	20	15	30	2.0	-	8.8	122
1200	48			300	X	6	0%	20	15	30	1.7	-	12.4	200
1400	56			300	X	6	0%	20	15	30	1.4	-	16.4	251
1600	64			300	X	6	0%	20	15	30	1.2	-	21.5	391
1800	72			300	X	6	0%	20	15	30	1.1	-	27.0	438
2000	80			300	X	6	0%	20	15	30	1.0	-	33.1	500
2200	88			300	X	6	0%	20	15	30	0.9	-	39.9	580
For any intermediate sizes and further sizes up to ND 2600mm (102"), please consult us.														
Type MA 60														
500	20		250	300	X	10	0%	30	30	30	6.8	-	2.6	54
600	24		250	300	X	10	0%	30	30	30	5.7	-	3.6	68
800	32		250	300	X	10	0%	30	30	30	4.3	-	6.1	98
1000	40		250	300	X	10	0%	30	30	30	3.4	-	9.1	135
1200	48			300	X	10	0%	30	30	30	2.9	-	12.8	215
1400	56			300	X	10	0%	30	30	30	2.4	-	17.2	273
1600	64			300	X	10	0%	30	30	30	2.1	-	22.1	405
1800	72			300	X	10	0%	30	30	30	1.9	-	27.7	454
2000	80			300	X	10	0%	30	30	30	1.7	-	33.9	514
2200	88			300	X	10	0%	30	30	30	1.6	-	40.7	617
For any intermediate sizes and further sizes up to ND 2600mm (102"), please consult us.														
Type MB 60														
500	20		250	300	X	8	100%	30	10	30	4.6	4.6	2.6	61
600	24		250	300	X	8	100%	30	10	30	3.8	3.8	3.6	77
800	32		250	300	X	8	100%	30	10	30	2.9	2.9	6.1	109
1000	40		250	300	X	8	100%	30	10	30	2.3	2.3	9.1	149
1200	48			300	X	8	100%	30	10	30	1.9	1.9	12.8	232
1400	56			300	X	8	100%	30	10	30	1.6	1.6	17.2	290
1600	64			300	X	8	100%	30	10	30	1.4	1.4	22.1	426
1800	72			300	X	8	100%	30	10	30	1.3	1.3	27.7	477
2000	80			300	X	8	100%	30	10	30	1.1	1.1	33.9	550
2200	88			300	X	8	100%	30	10	30	1.0	1.0	40.7	645
For any intermediate sizes and further sizes up to ND 2600mm (102"), please consult us.														

(1) Steel retaining flanges in 1 part (zinc-chromated, hot-dip galvanized or stainless steel)

Distributor:

Mercia Flexibles • www.merciaflexibles.co.uk
 Ludlow Business Park • Ludlow • Shropshire • SY8 1XF • United Kingdom
 Tel: +44 (0)1584 874999 • Fax: +44 (0)1584 874007 • Email: enquiries@merciflexibles.co.uk

Technical Sheet
AFD-TS- 006/3 from 2008 - 11 - 20

We reserve the right to change our products' specifications when necessary without notice.